

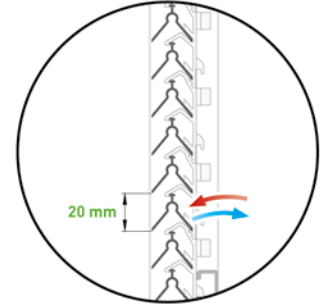

Good water resistance Penetration safety



DucoGrille Classic 20V

DucoGrille Classic 20V consists of two different types: a recessed wall louvre (G) and an architectural window louvre (F). All types are manufactured from extruded aluminium sections. Insect mesh is fitted as standard. The “V”-shaped louvre blade produces a sleek design.

FRAME TYPES AND DIMENSIONS

Dimensions in mm	G	F
Louvre pitch	20	
Recess depth	30	-
Frame rebate	19	-
Flange width	-	24
Frame depth	-	35
Min. dimensions	min. W 200 x H 200	

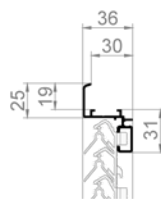

G 20V

Recessed wall louvre
with flange

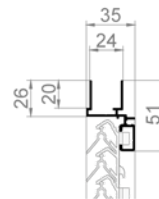

F 20V

Window louvre

VENTILATION VALUES

Visual free passage	95 %
Physical free passage	34 %
Ce (higher is better)	0,15
Cd (higher is better)	0,15
K-FACTOR (lower is better)	INLET 42,93
	OUTLET 47,1

WATER RESISTANCE

Air velocity	Class
0 m/s	A (99,0%)
0,5 m/s	B
1 m/s	C (91,5%)
1,5 m/s	C
2 m/s	C
2,5 m/s	D

INSECT SCREEN

STANDARD	Stainless-steel mesh 2.3 x 2.3 mm
OPTION	Stainless-steel mesh 6 x 6 mm
	Stainless-steel mesh 20 x 20 mm