



L30-Access



- > Linear panel
- > Radiant heating
- > Plasterboard mounting
- > Low profile

APPLICATION

The L30 is an extruded aluminium radiant heating strip that provides exceptionally high heat transfer. It offers a modular indoor solution that has been designed to fit flush in a standard plasterboard ceiling with a supplied, made to measure fixing frame. Operating with a proven water-based heat exchange system that will operate from a boiler.

FEATURES	
Mean water temp:	45°C to 80°C
Max. length:	up to 4200 mm
Coil passes:	2,4,6,8,10 & 12

DESIGN

Casing		
material:	extruded aluminium planks	
finish:	white polyester powder coating	
colour:	RAL 9003 (matt)	
Pipework		
16 mm tubes:	copper	
Clips		
joint/suspension:	cadmium or zinc-plated steel	
Insulation		
material:	rFOIL™	

AVAILABLE TYPES

L30	
L	linear panel
30	595 mm width
	– heating LTHW
	– cooling CHW
	– access integrated access panel
Options	
	– perforated
	– anti-bacterial coating

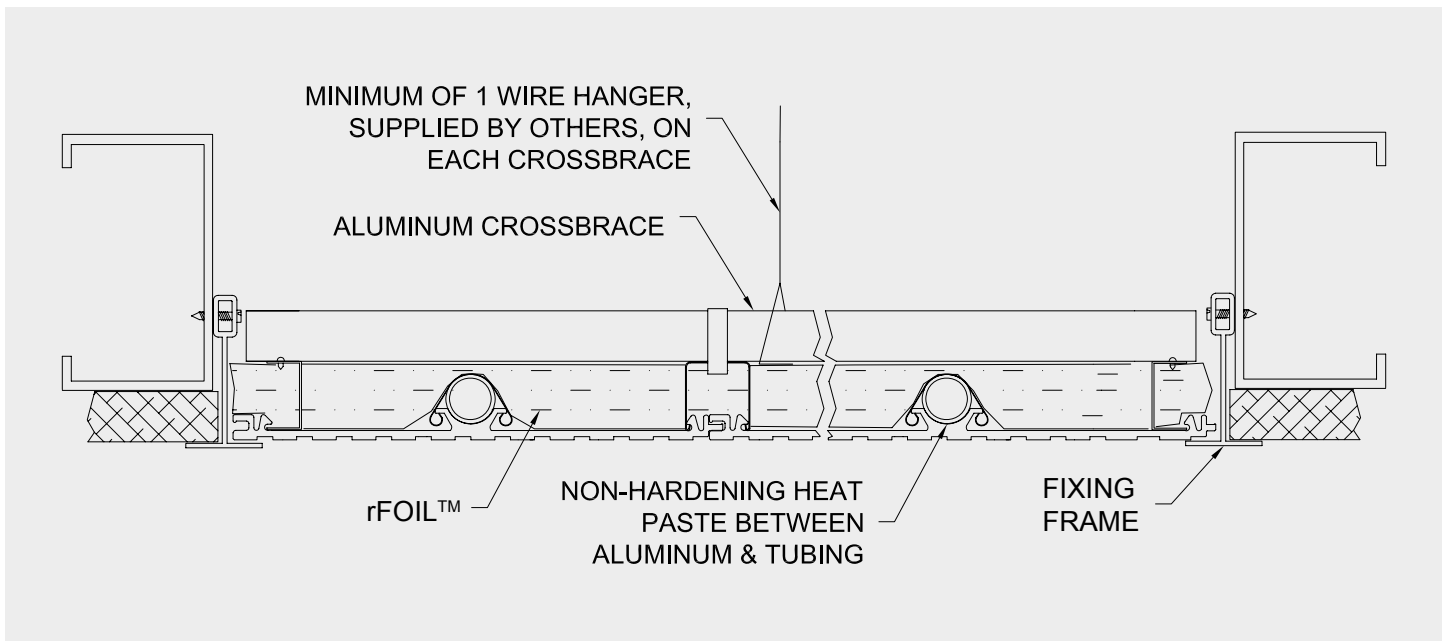

REMARKS

All dimensions are given in mm.
Copper pipework has 15 mm brazed ends.

L30 PERFORMANCE DATA

L30 PERFORMANCE	Width (mm)	Mean Water Temperature °C							
		45	50	55	60	65	70	75	80
2 PASSES	300	74	91	98	146	158	182	217	231
4 PASSES	300	81	99	108	160	174	200	238	254
4 PASSES	450	101	124	135	200	218	250	297	318
6 PASSES	450	114	140	151	222	242	285	329	352
4 PASSES	600	150	187	201	258	294	336	367	406
6 PASSES	600	156	195	209	269	308	350	386	427
8 PASSES	600	163	204	217	281	323	364	406	448
6 PASSES	750	176	224	238	309	355	400	446	501
8 PASSES	750	188	235	249	324	373	420	468	530
10 PASSES	750	197	247	261	340	392	441	491	560
8 PASSES	900	221	277	2925	381	439	494	549	636
10 PASSES	900	228	285	301	392	452	508	565	653
12 PASSES	900	235	293	310	403	466	523	581	671

Outputs expressed in watts per linear metre and are based on 21°C room temperature.
For every 1°C decrease in temperature below 21°C, the output increases by 2%.