

# L35

EN 442 & EN 14037 tested

- > Linear Wall Radiant Panel
- > Water Based Heat Exchange
- > Wall Mounted

## DESCRIPTION

The L35 is an extruded aluminium radiant heating strip that provides exceptionally high heat transfer. It offers a modular indoor solution that has been designed specifically for wall mounting. Operating with a proven water-based heat exchange system that operates from a boiler.

### Fixing:

Cadmium or zinc-plated steel joint or suspension clips. Joining cover strip available for extension.

## CONSTRUCTION

Extruded aluminium planks, copper tubing with 15 mm connection and rFoil™ insulation.

**Finish:** RAL 9003 (matt) as standard.

### Options:

- anti-bacterial coating
- connection types
- access panel

## FEATURES

Mean water temp: 45°C to 80°C

Coil passes: 4, 6, 8, 10, 12, 14

Max. length: up to 4,800 mm  
(in one piece)

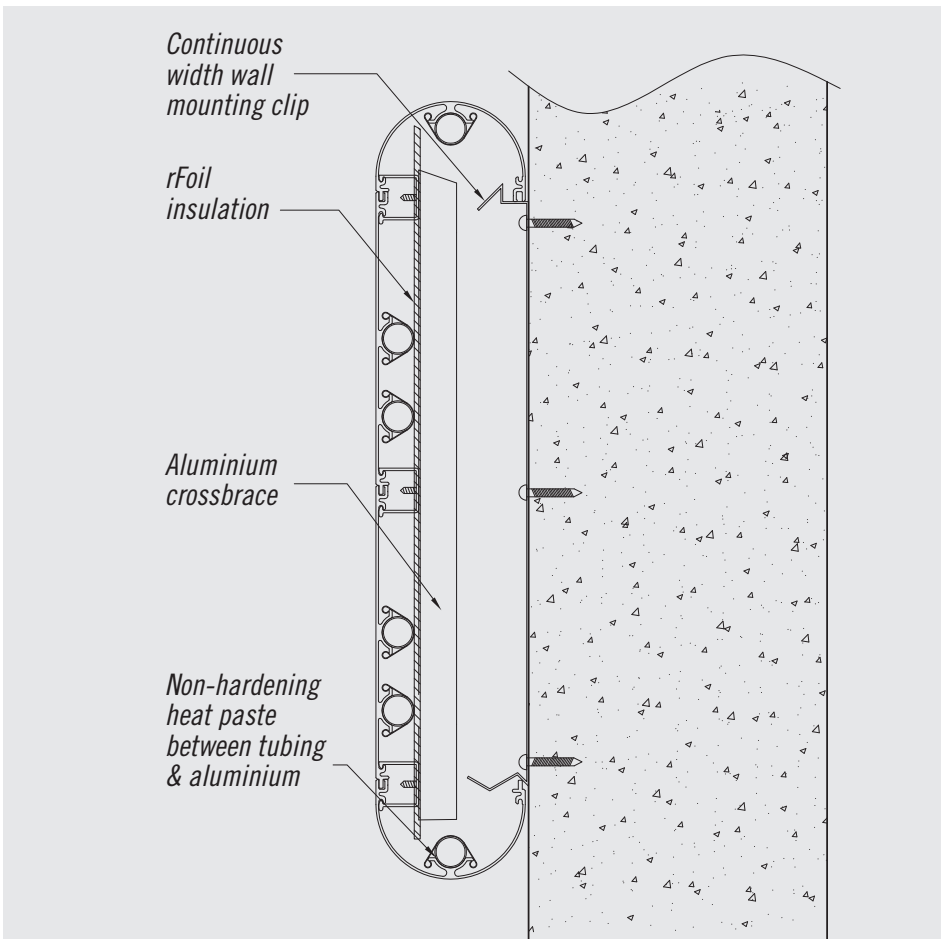

# L35 – SELECTION DATA

L35 SELECTION DATA										
Mean Water Temperature										
		Passes	45 °C	50 °C	55 °C	60 °C	65 °C	70 °C	75 °C	80 °C
Width (mm)	450	4	101	124	135	200	218	250	297	318
	600	4	150	187	201	258	294	336	367	406
		6	156	195	209	269	308	350	386	427
	750	6	179	224	238	309	355	400	446	501
		8	188	235	249	324	373	420	468	530
	900	8	221	277	292	381	439	494	549	636
		10	228	285	301	392	452	508	565	653
	1050	10	258	322	341	443	513	575	639	743
		12	266	332	351	456	528	592	658	763
	1200	12	296	368	389	506	586	658	732	849
		14	305	379	400	521	603	677	754	872
	1350	12	334	413	437	568	658	739	823	955
		14	344	425	450	585	677	761	848	982

## KEY INFORMATION

Outputs expressed in watts per linear metre and are based on 21°C room temperature. For every 1°C decrease in temperature below 21°C, the output increases by 2%.